



## ERIE BIKEWAYS PROJECT

- Background
  - Long Range Transportation Plan
  - Active Erie and the Low-Stress Bike Network
- Greengarden Boulevard Bikeway
- French Street Bikeway
- Next Steps

## BIKE ERIE BIKE ROUTES

### Erie City Bike Routes

courtesy of Bike Erie

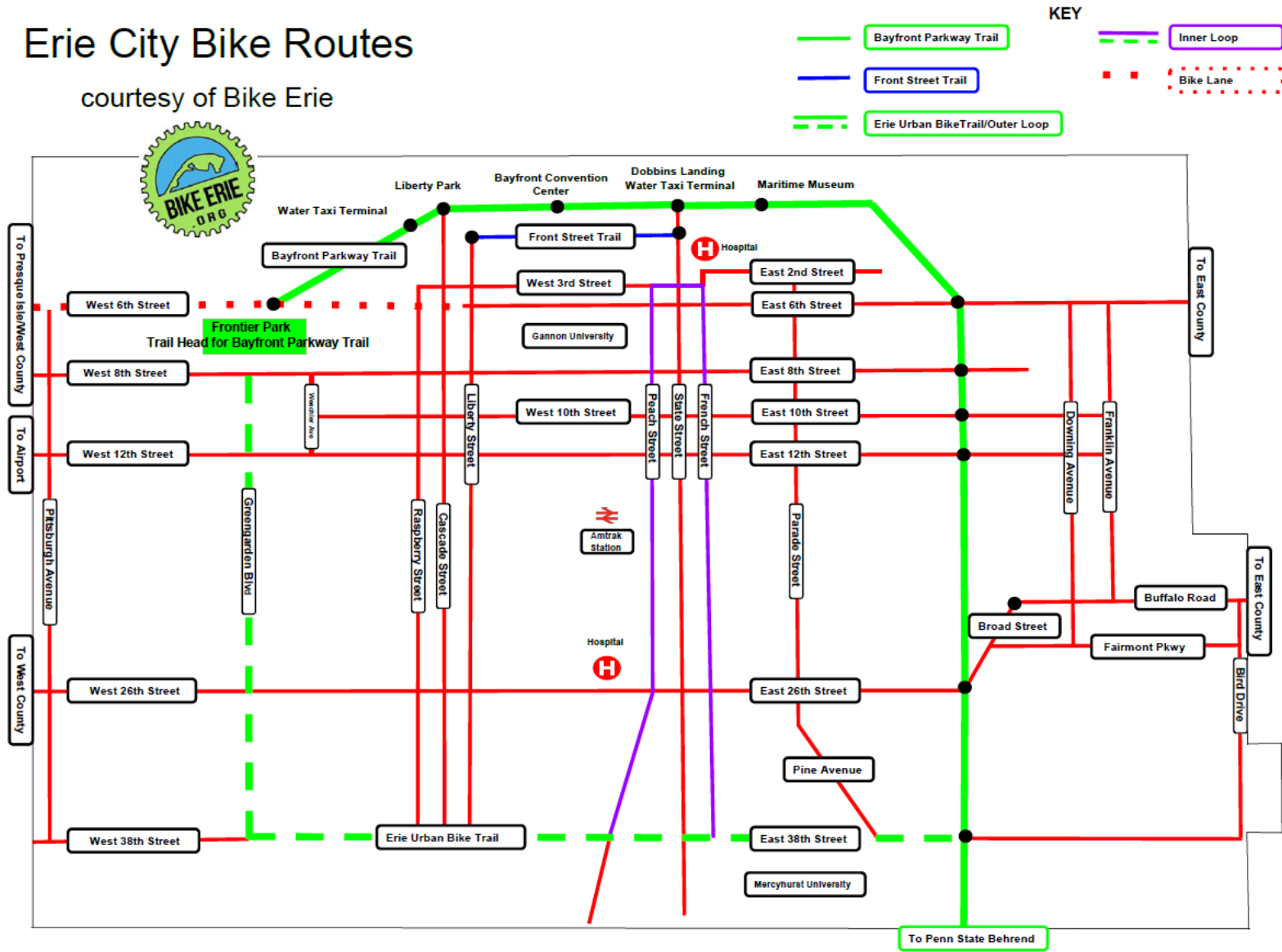



## ERIE LONG-RANGE TRANSPORTATION PLAN (2017)



# ERIE LONG-RANGE TRANSPORTATION PLAN (2017)

**Exhibit 49b – Pedestrian and Bicycle Projects (Descriptions)**

ID	Title	Municipality	Description
5b	Erie Loop Bikeway - Greengarden Boulevard	City of Erie	Construct the western limit of the Erie Loop Bikeway through providing bicycle lanes on Greengarden Boulevard to separate cyclists from the general flow of traffic and minimize congestion and improve safety for motorists and cyclists. Restripe the current roadway geometry along Greengarden from 38th Street to Route 5 near Frontier Park. Potential improvements include dedicated bicycle lanes, sharrows, and Share the Road signs where geometry does not allow for exclusive bicycle lanes. Total limits should be approximately 2.5 mile section along Greengarden Boulevard between Route 5 and 38th Street.
5c	Erie Loop Bikeway - French Street	City of Erie	Construct the central trunk of the Erie Loop Bikeway by providing a cycle track to separate cyclists from the general flow of traffic. Minimize congestion and improve safety for motorists and cyclists by restriping one of the three existing travel lanes along French Street. Limits from approximately 38th Street in the south to UPMC and the Bayfront Parkway in the north. French Street is recommended over State Street due to its lower stress nature. The extensive roadway width in this section could accommodate a two-way cycle track with minimal impact to traffic operations; a delineated buffer area between the cycle track and travel lanes could be removed in the wintertime to accommodate snow plowing.

## ACTIVE ERIE TRANSPORTATION PLAN (2021)



## ACTIVE ERIE STEERING COMMITTEE

- City of Erie Traffic Engineer
- City of Erie Engineer
- City of Erie Fire
- City of Erie Planning Commission
- City of Erie Planning Director
- Erie Public Schools
- EMTA
- Erie Arts and Culture
- Erie Community Foundation
- Erie Downtown Partnership
- Mayor's Disability Roundtable
- Millcreek Township
- Erie County MPO
- Bike Erie
- Erie County Department of Health
- MCRC – Refugee Representative
- PennDOT District 1



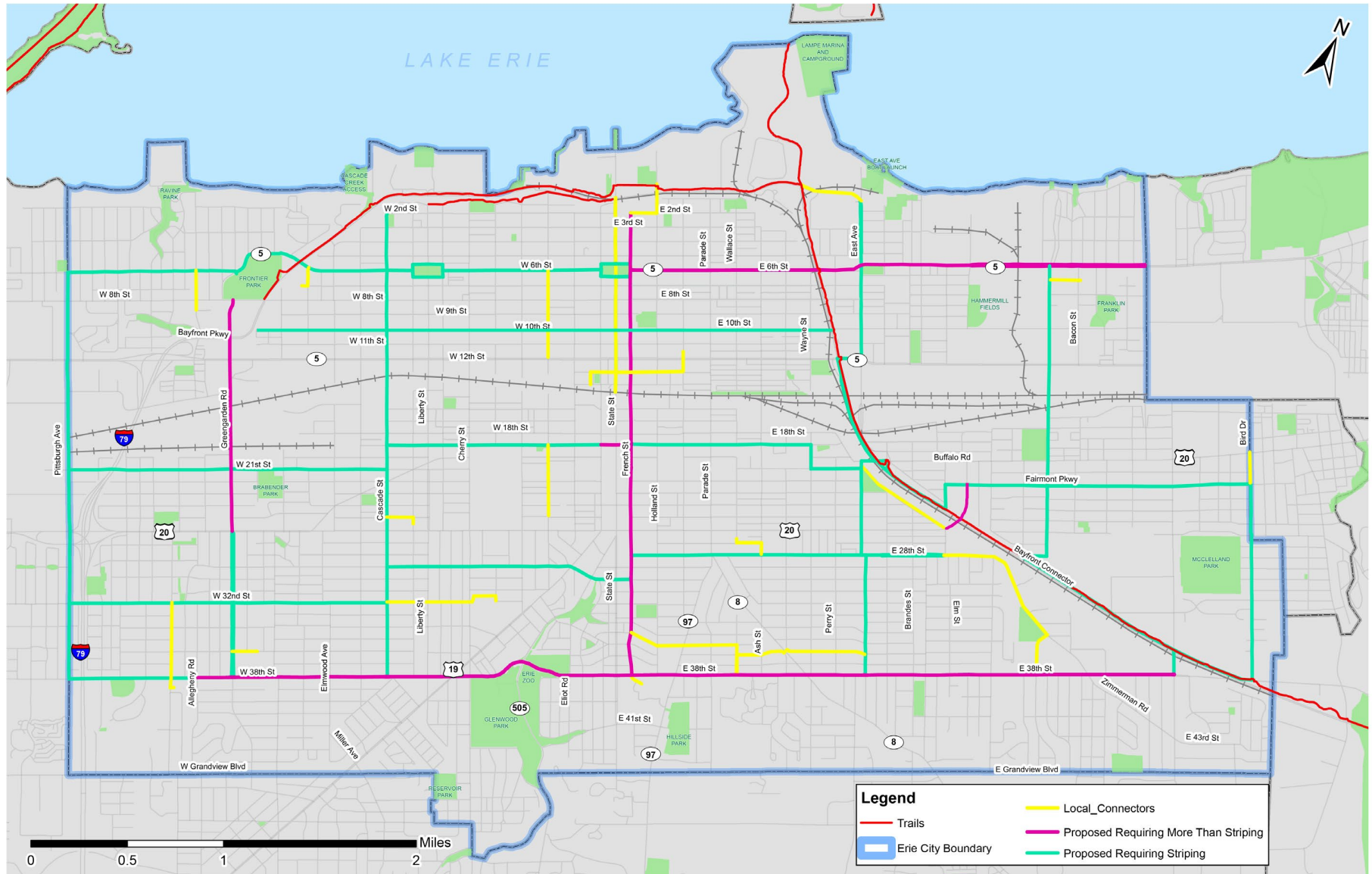



## ACTIVE ERIE LOW-STRESS BIKEWAY NETWORK

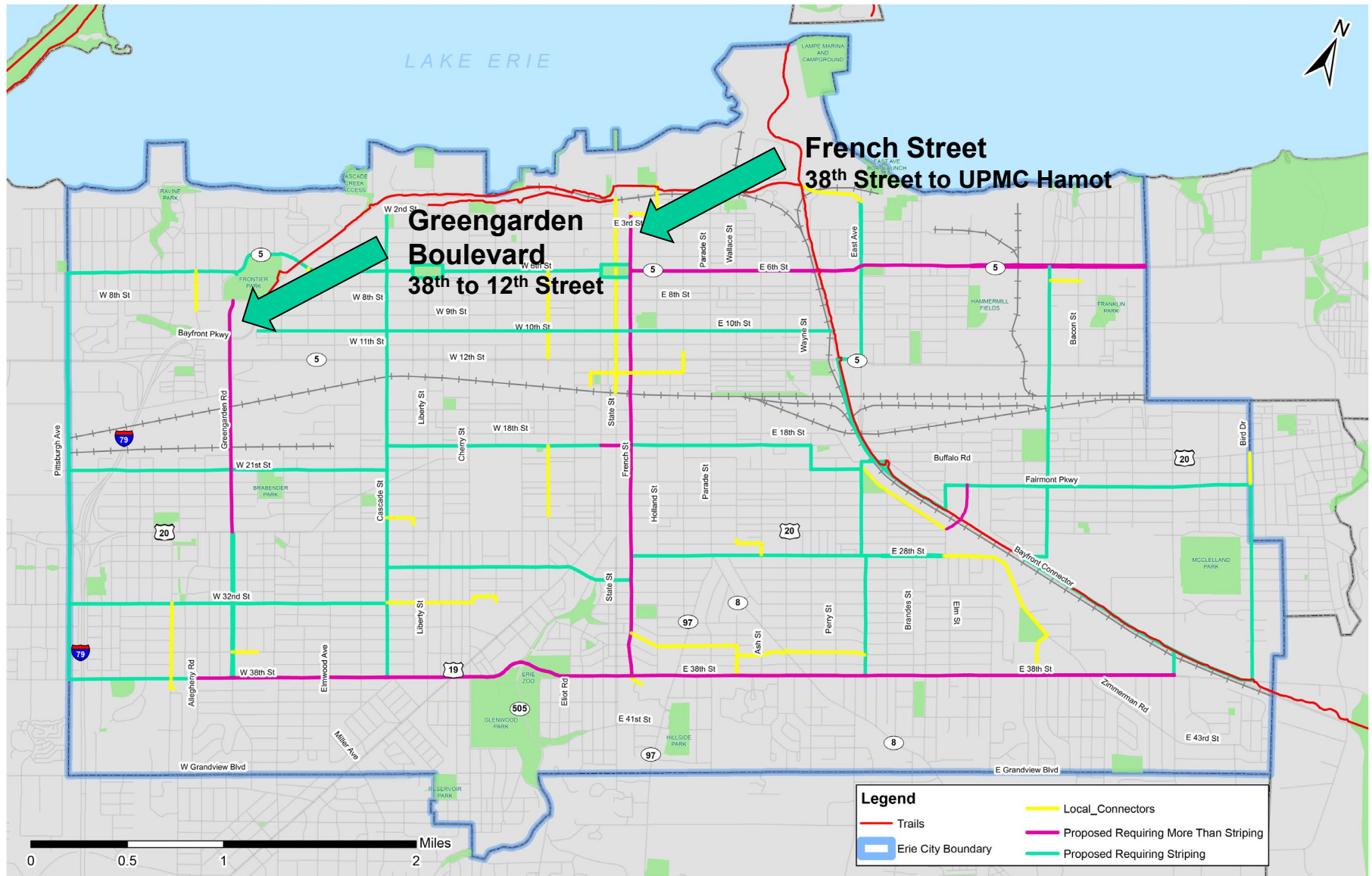

## ENVIRONMENTAL REVIEW PROCESS

- Required by National Environmental Policy Act (NEPA)/ Section 4(f) for any projects funded by or requiring approval by the U.S. Department of Transportation
- Requires an assessment of the proposed project's impact on:
  - Park and recreational lands
  - Wildlife and waterfowl refuges
  - Historic sites
- Because both proposed projects consist of pavement markings and signal improvements, it was found that there are no adverse impacts
- If you have concerns about any impacts to parks or historic sites, please note your concerns via the online survey or comment form available at <https://cityof.erie.pa.us/bikeway/>

# Greengarden Boulevard Bikeway

## BAYFRONT PARKWAY TO 38<sup>TH</sup> STREET

Destinations along the Greengarden Boulevard Bikeway include employment centers, retail opportunities, and Grover Cleveland Elementary School.

This project includes:

- Funding for pavement markings
  - Shared lane markings (sharrows) between Bayfront Parkway and 12th Street
  - Buffered bike lanes between 12<sup>th</sup> Street and 16<sup>th</sup> Street
  - Standard bike lanes between 16<sup>th</sup> Street and 25<sup>th</sup> Street
  - Shared lane markings (sharrows) between 25<sup>th</sup> Street and 26<sup>th</sup> Street
  - Buffered bike lanes between 26<sup>th</sup> Street and 38<sup>th</sup> Street
- Bike facilities will be accommodated via lane narrowing and removal of on-street parking



# Greengarden Boulevard Bikeway

## TYPICAL SECTION

Greengarden Blvd - Bayfront Parkway to West 12th Street

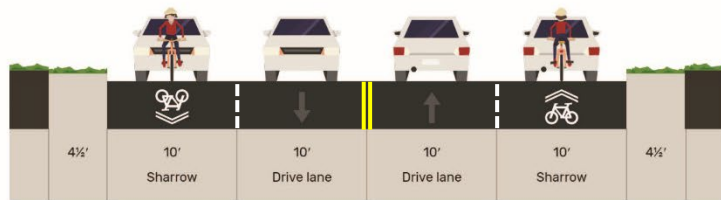

Interim treatment - Sharrows



# Greengarden Boulevard Bikeway

## TYPICAL SECTION

### Greengarden Blvd - West 12th Street to West 16th Street

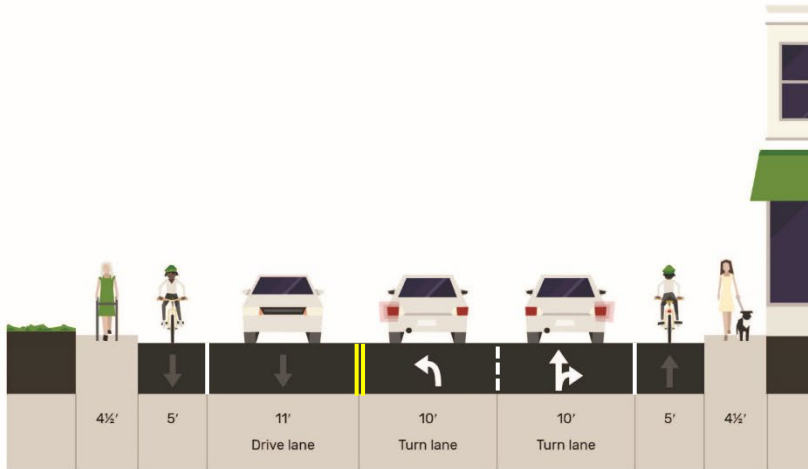

Intersection with left turn lane and bike lanes

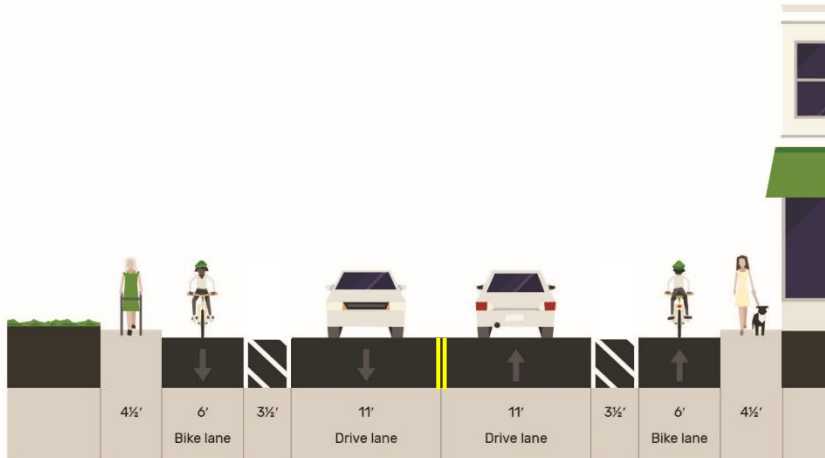

One travel lane each way with buffered bike lanes



Existing Accessible Pedestrian Signal (APS)



# Greengarden Boulevard Bikeway

## TYPICAL SECTION

Greengarden Blvd - West 16th Street to West 21st Street



One travel lane each way with bike lanes

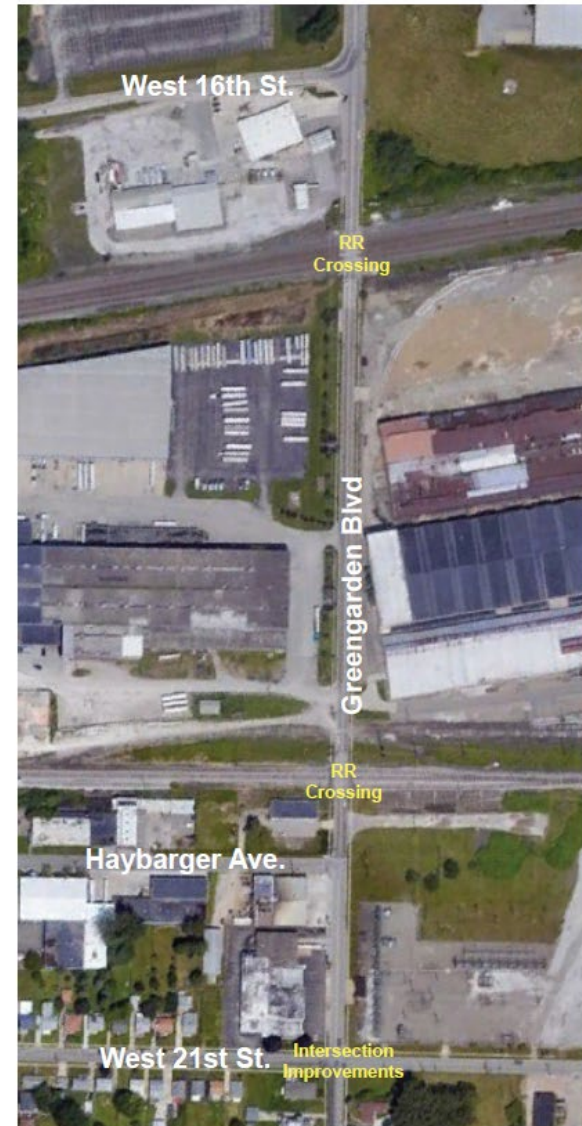



# Greengarden Boulevard Bikeway

## TYPICAL SECTION

### Greengarden Blvd – West 21<sup>st</sup> Street to West 25<sup>th</sup> Street

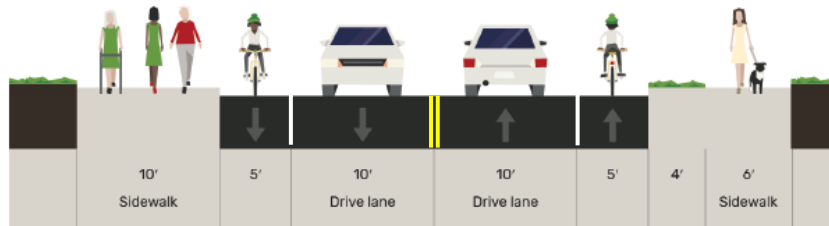

One travel lane each way with bike lanes

### Greengarden Blvd – West 25<sup>th</sup> Street to West 26<sup>th</sup> Street

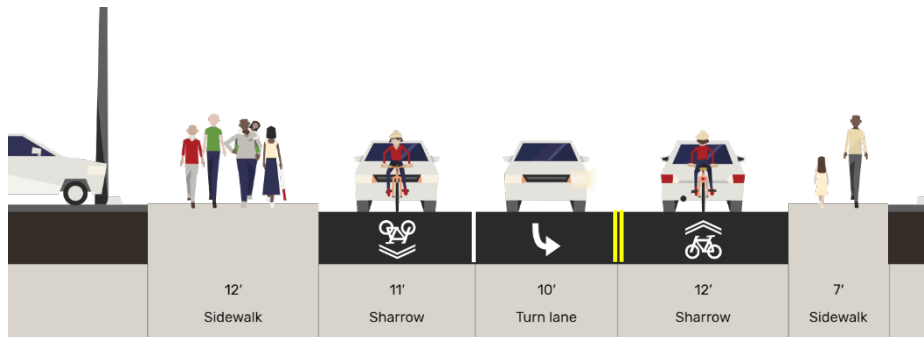

# Greengarden Boulevard Bikeway

## TYPICAL SECTION

Greengarden Blvd - West 26th Street to West 32nd Street



One travel lane each way with buffered bike lanes

**These blocks will now have buffered bike lanes instead of on-street parking.**

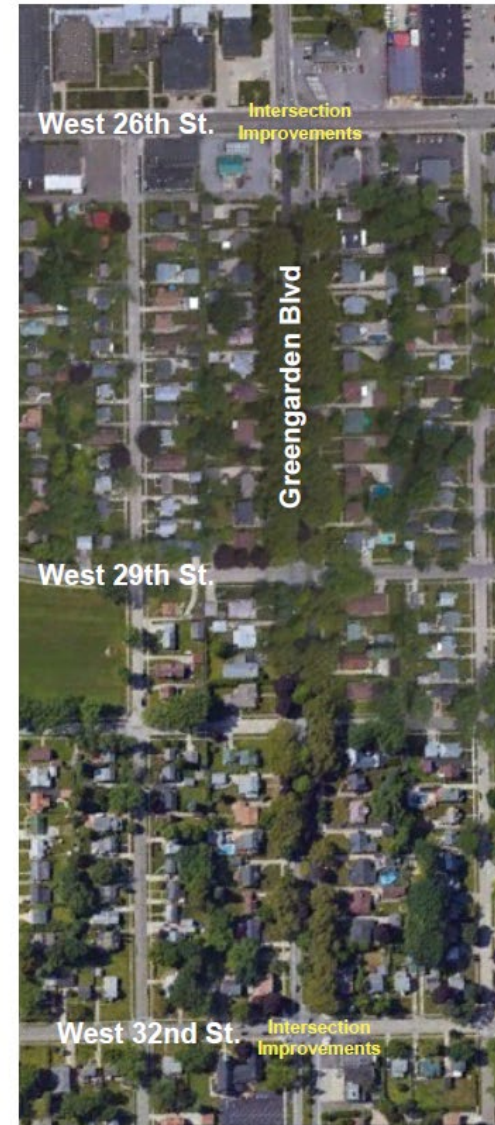

# Greengarden Boulevard Bikeway

## TYPICAL SECTION

Greengarden Blvd - West 32nd Street to West 38th Street



One travel lane each way with buffered bike lanes

**These blocks will now have buffered bike lanes instead of on-street parking.**





# Greengarden Boulevard Bikeway

FULL PLAN SETS AVAILABLE FOR REVIEW ONLINE

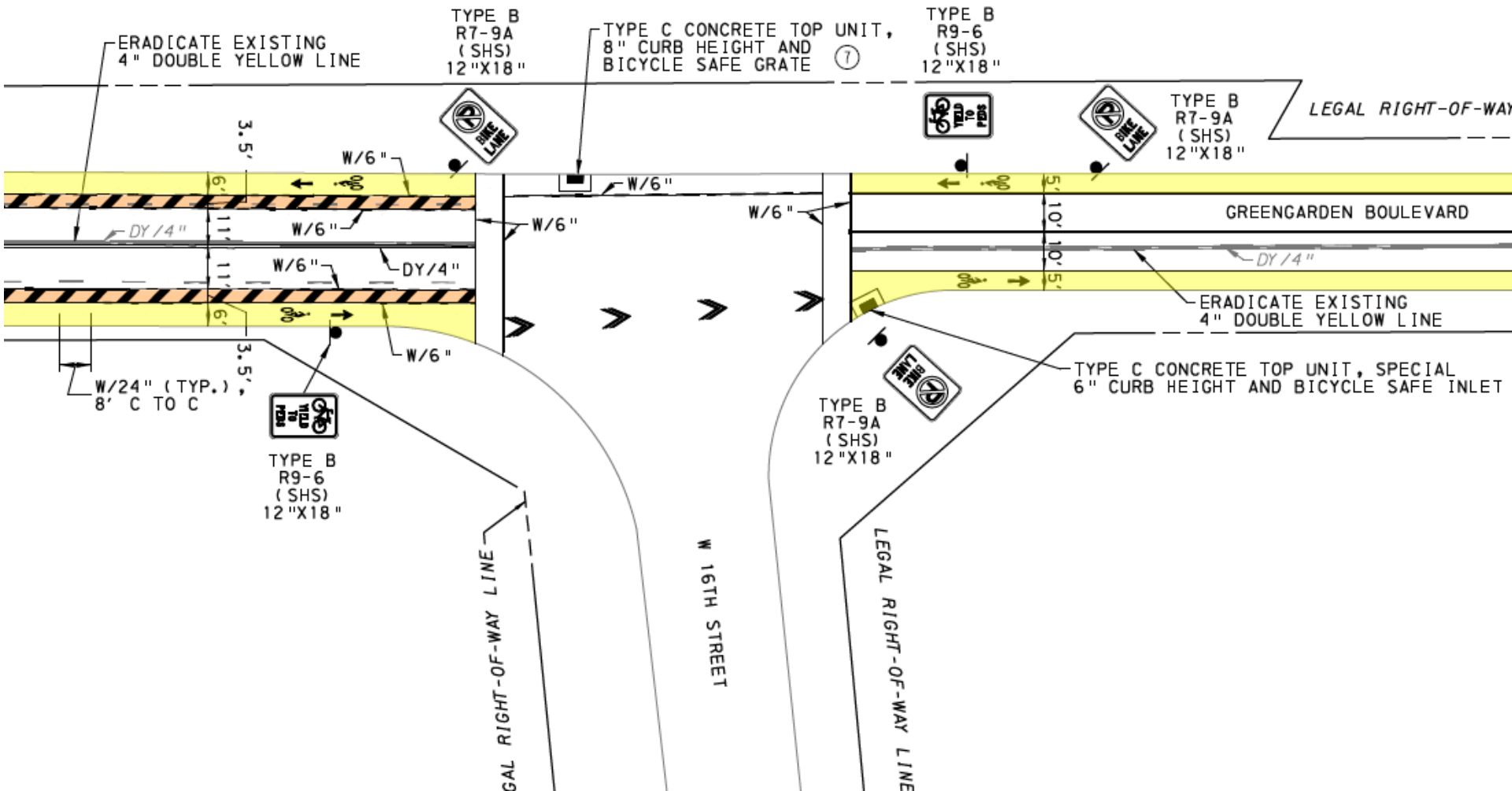

Visit <https://cityof.erie.pa.us/bikeway/>

## DOWNTOWN MASTER PLAN (2016)

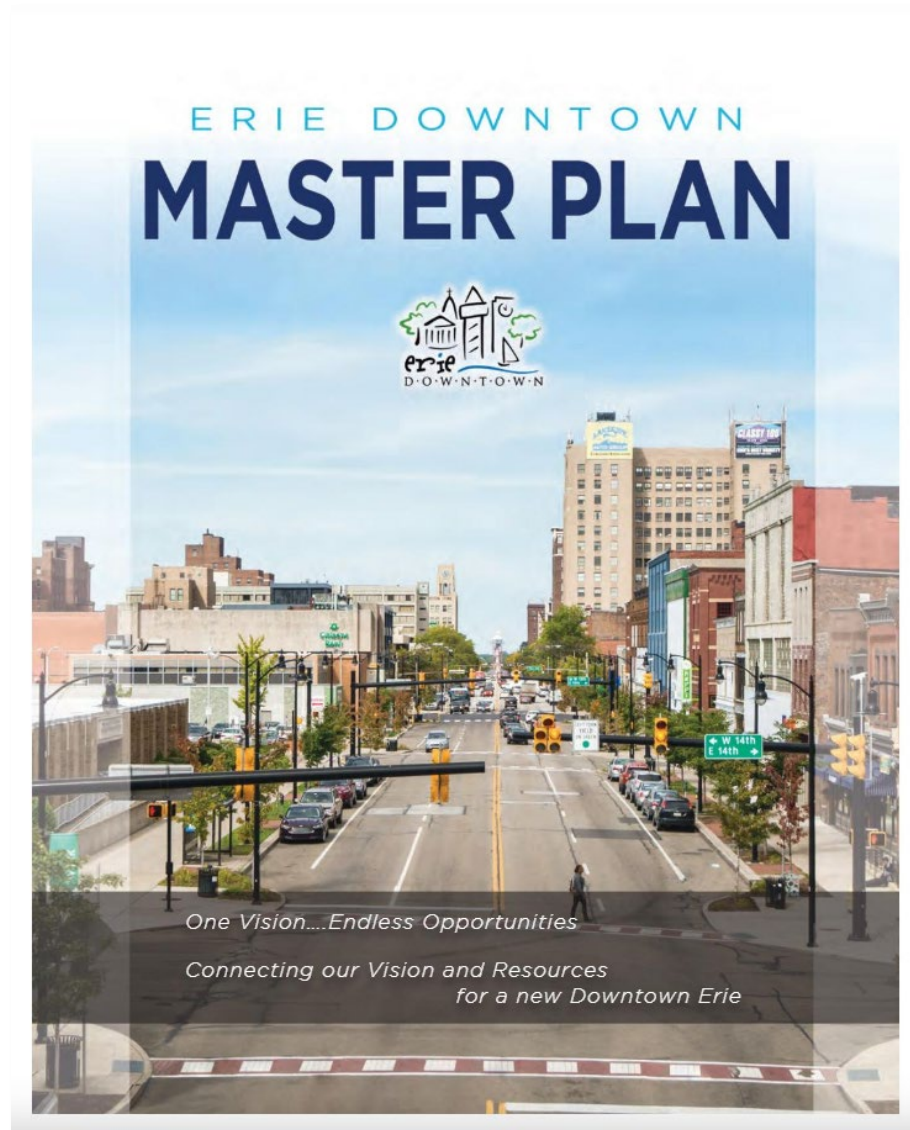

# French Street Bikeway

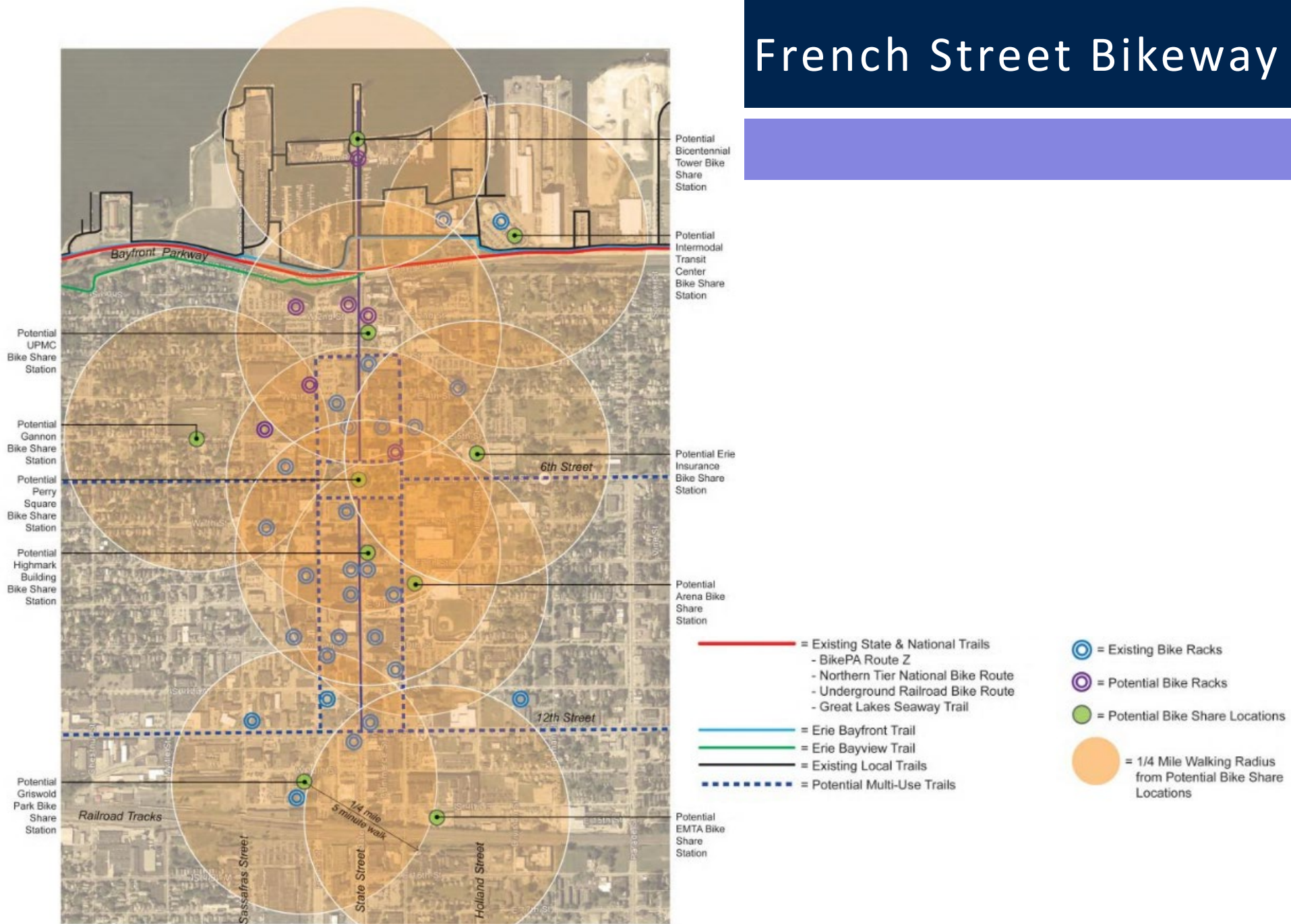

Plate 3-4: Pedestrian/Bike Multi-Use Trails Diagram

# French Street Bikeway

## 6<sup>TH</sup> STREET TO 38<sup>TH</sup> STREET

Destinations along French Street include Downtown, UPMC Park, Witherspoon Park, Erie Veterans Memorial Stadium, and Northwest Pennsylvania Collegiate Academy.

This project includes

- Funding for paint and signalization
  - Two-way separated bike lane from 6<sup>th</sup> Street to 26<sup>th</sup> Street
    - Located on east side of street from 6<sup>th</sup> Street to 11<sup>th</sup> Street in order to maintain bump outs and bus stops
    - Transitions to west side of street from 11<sup>th</sup> Street through 26<sup>th</sup> Street
  - Sharrows on low-stress portion of French Street between 26<sup>th</sup> Street and 38<sup>th</sup> Street
- Bike facilities accommodated via road diet (removal of motor vehicle lane) and removal of on-street parking



# French Street Bikeway

6<sup>TH</sup> STREET TO 26<sup>TH</sup> STREET – TWO WAY SEPARATED BIKE LANE



# French Street Bikeway

## 6<sup>TH</sup> STREET TO 26<sup>TH</sup> STREET – TWO WAY SEPARATED BIKE LANE

- Design of the two-way separated bike lane was based on guidance from the Federal Highway Administration *Separated Bike Lane Planning and Design Guide*
- Implementation will require extensive coordination with Erie Parking Authority and local businesses due to on-street parking impacts
- Three signals will be redesigned using funding from PennDOT Green Light Go program
- Southbound bikes will use overhead traffic signals
- Northbound bikes will use bike signal heads

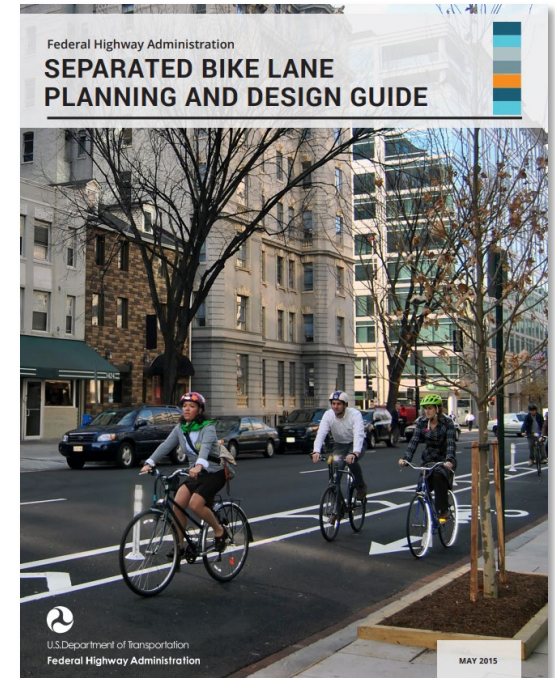



# French Street Bikeway

## TYPICAL SECTION

### French Street - E. 6th St. to E. 7th St.

#### E. 6th Street to South Park Row

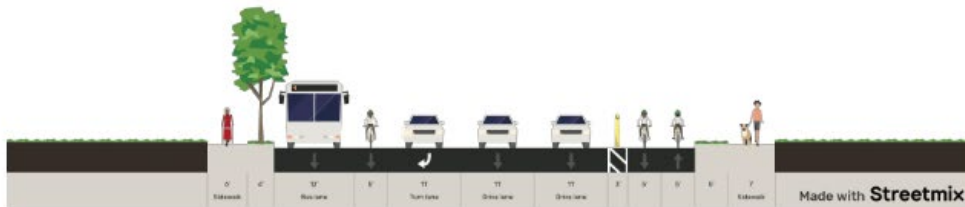

Two one-way travel lanes with right turn lane, angled parking and buffered two-way cycle track  
51' - 53' curb-to-curb width

#### South Park Row to E. 7th St.



Two one-way travel lanes and buffered two-way cycle track  
35.75' curb-to-curb width

 Existing Accessible Pedestrian Signal (APS)

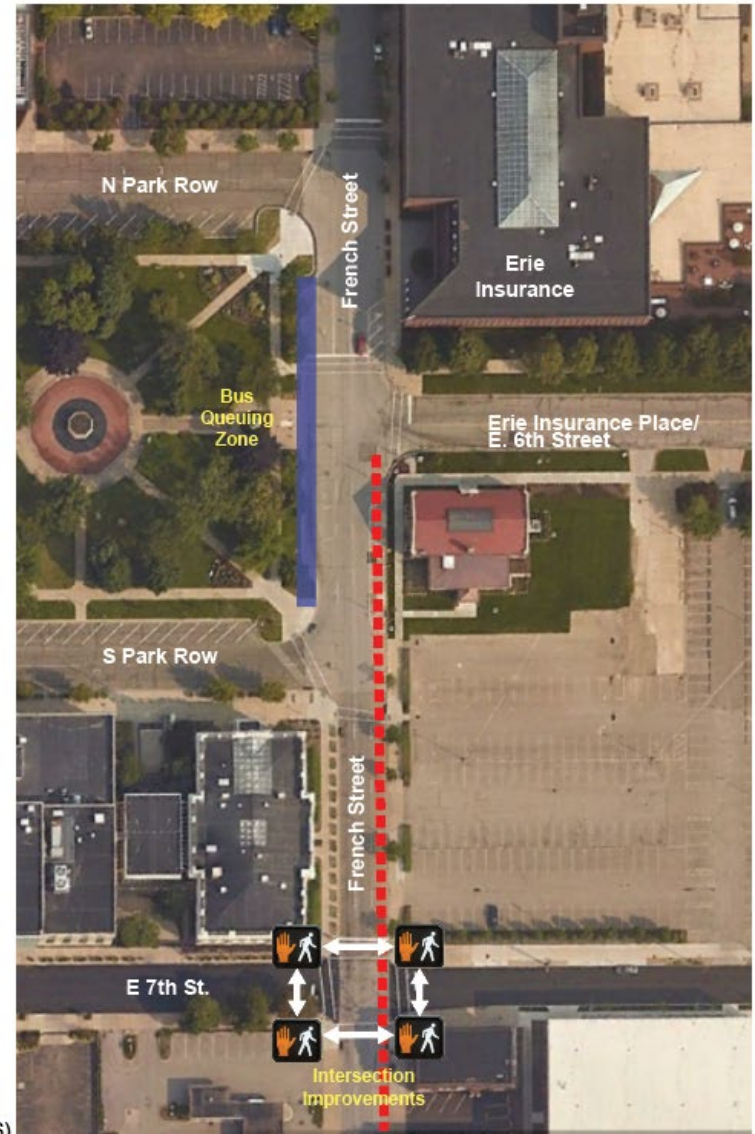

# French Street Bikeway

## NORTHBOUND BIKE ACCESS TO E. 6<sup>TH</sup> STREET & POINTS EAST

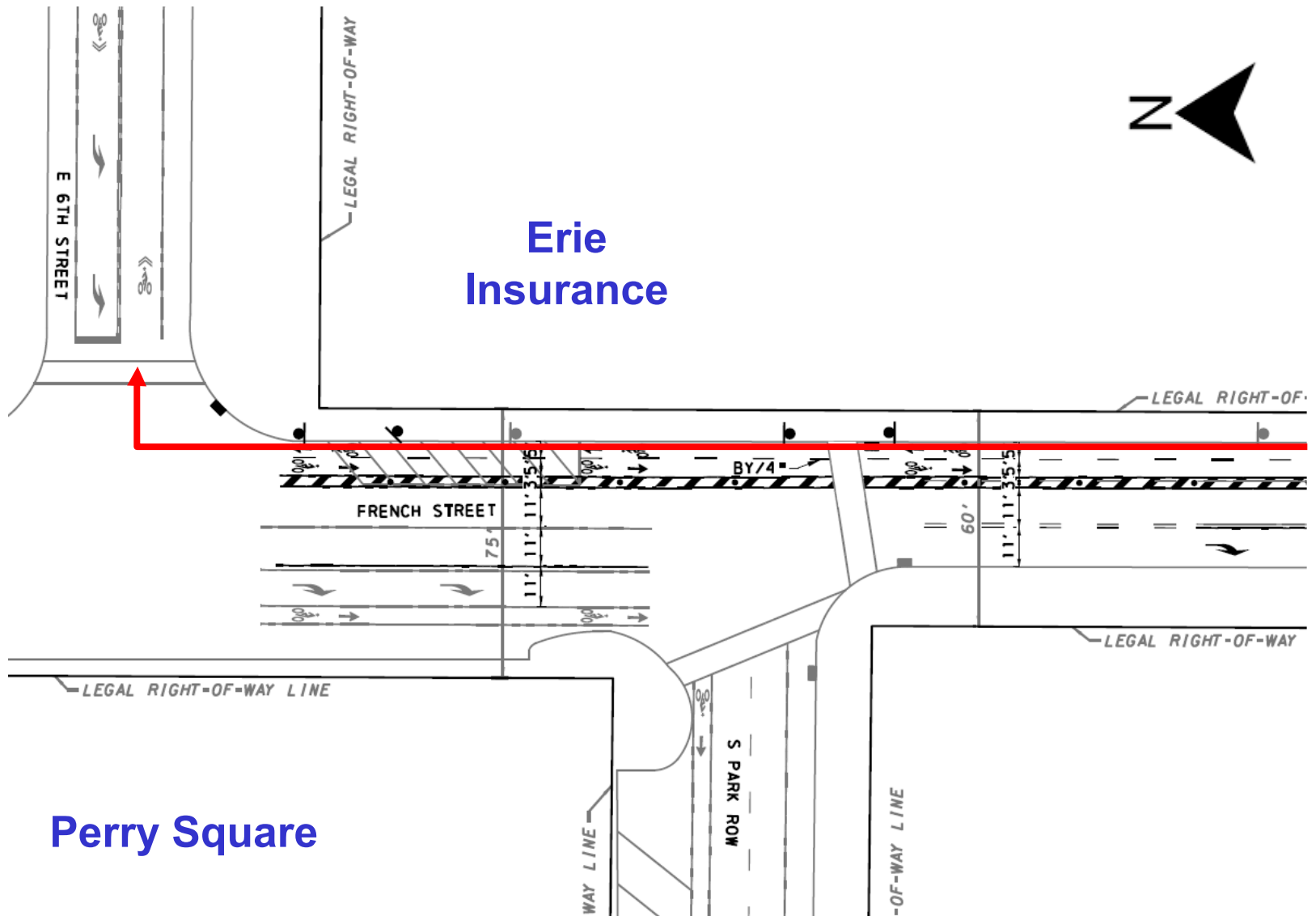



# French Street Bikeway

## NORTHBOUND BIKE ACCESS TO S. PARK ROW & POINTS WEST

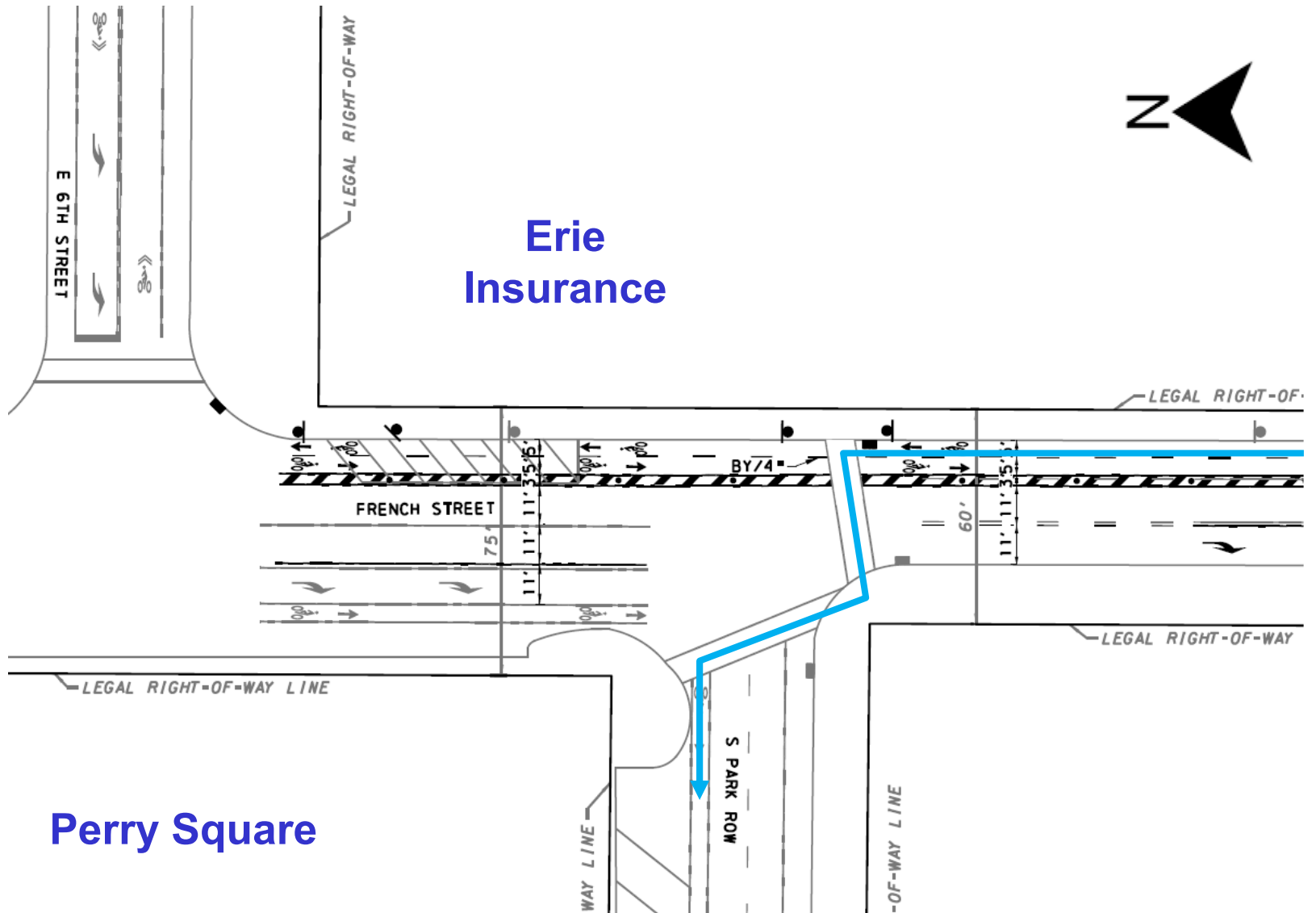

# French Street Bikeway

## WESTBOUND BIKE ACCESS TO FRENCH STREET & POINTS SOUTH

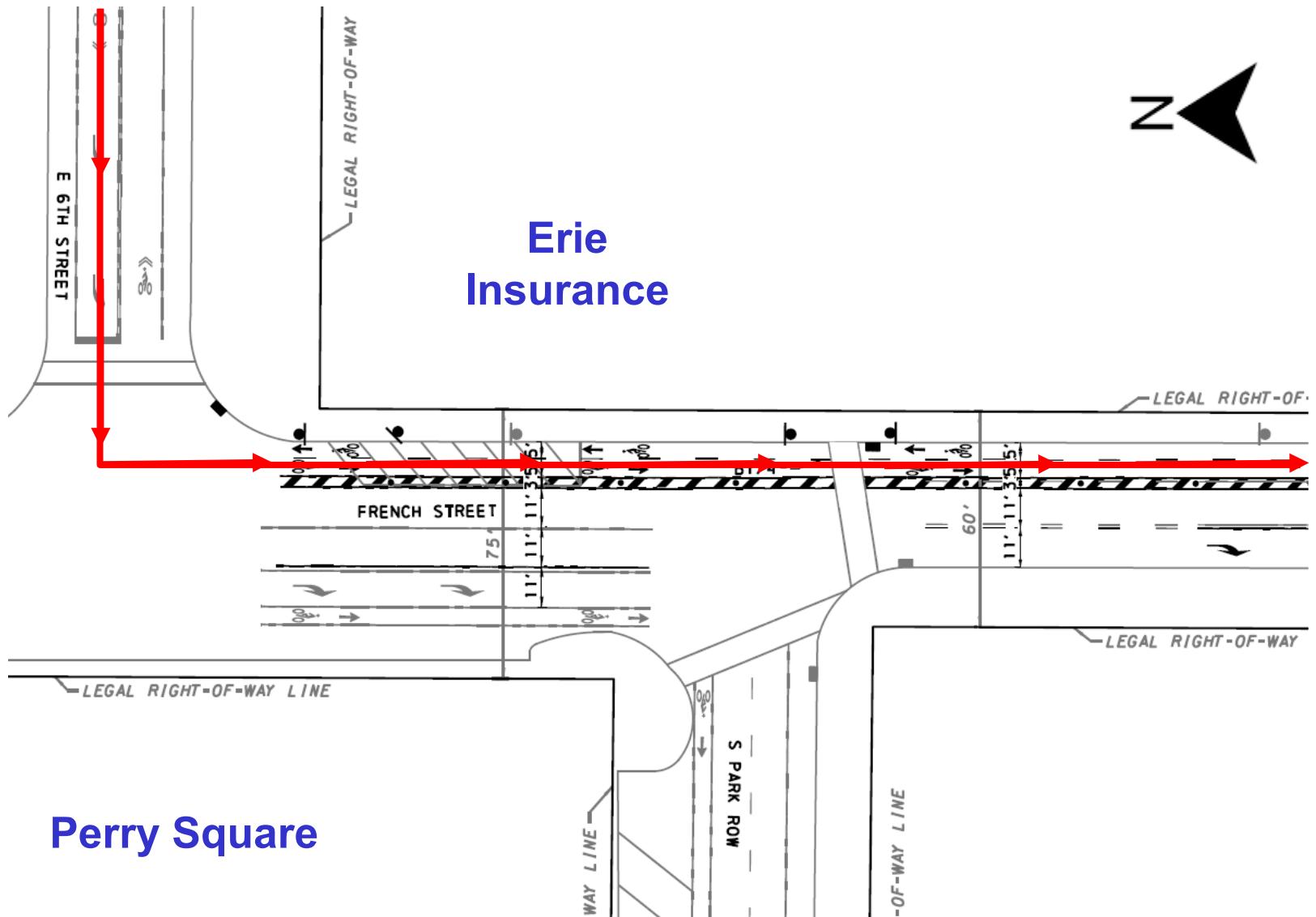

# French Street Bikeway

## WESTBOUND BIKE ACCESS TO S. PARK ROW & POINTS WEST

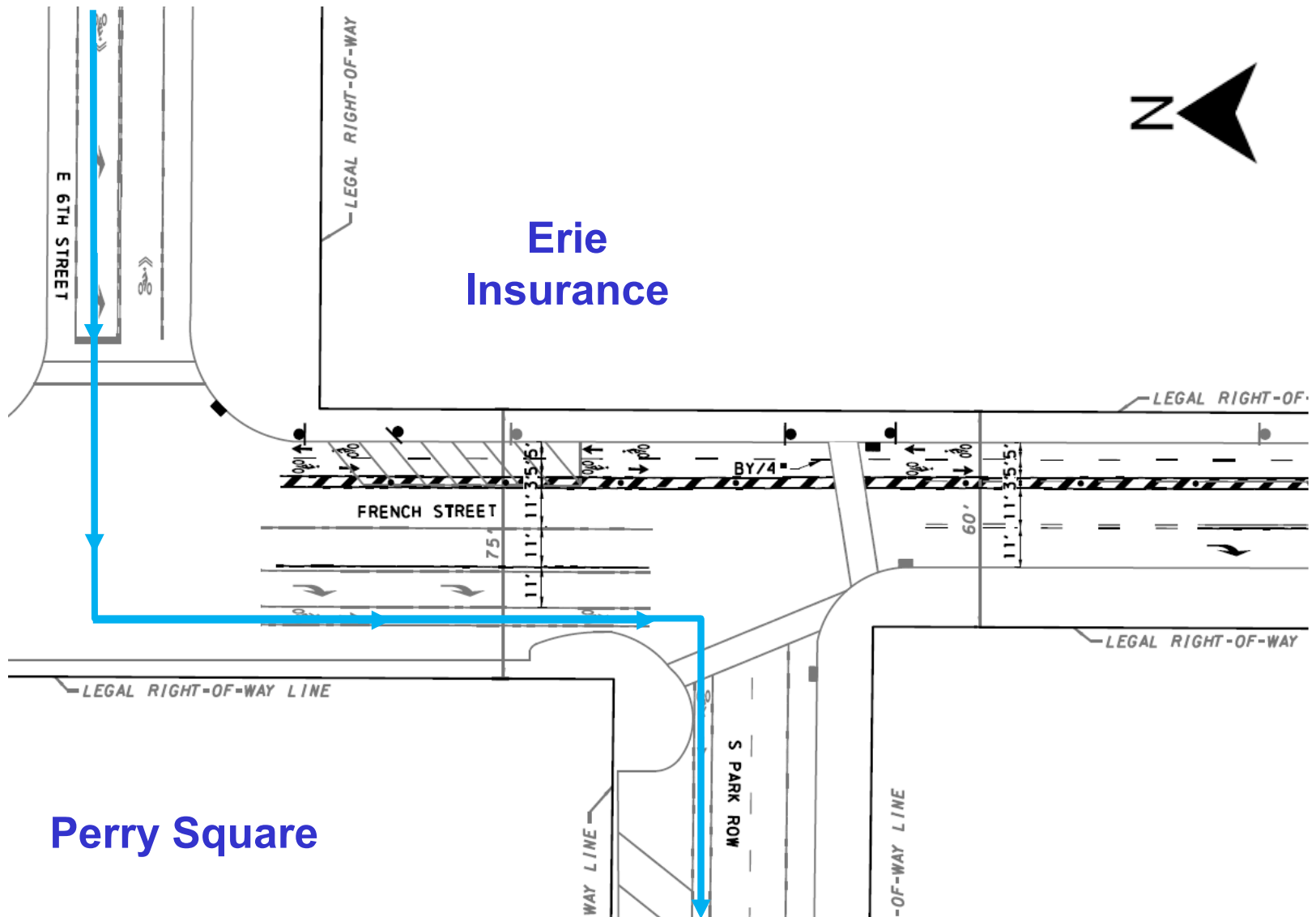

# French Street Bikeway

## SOUTHBOUND BIKE ACCESS TO FRENCH STREET & POINTS SOUTH

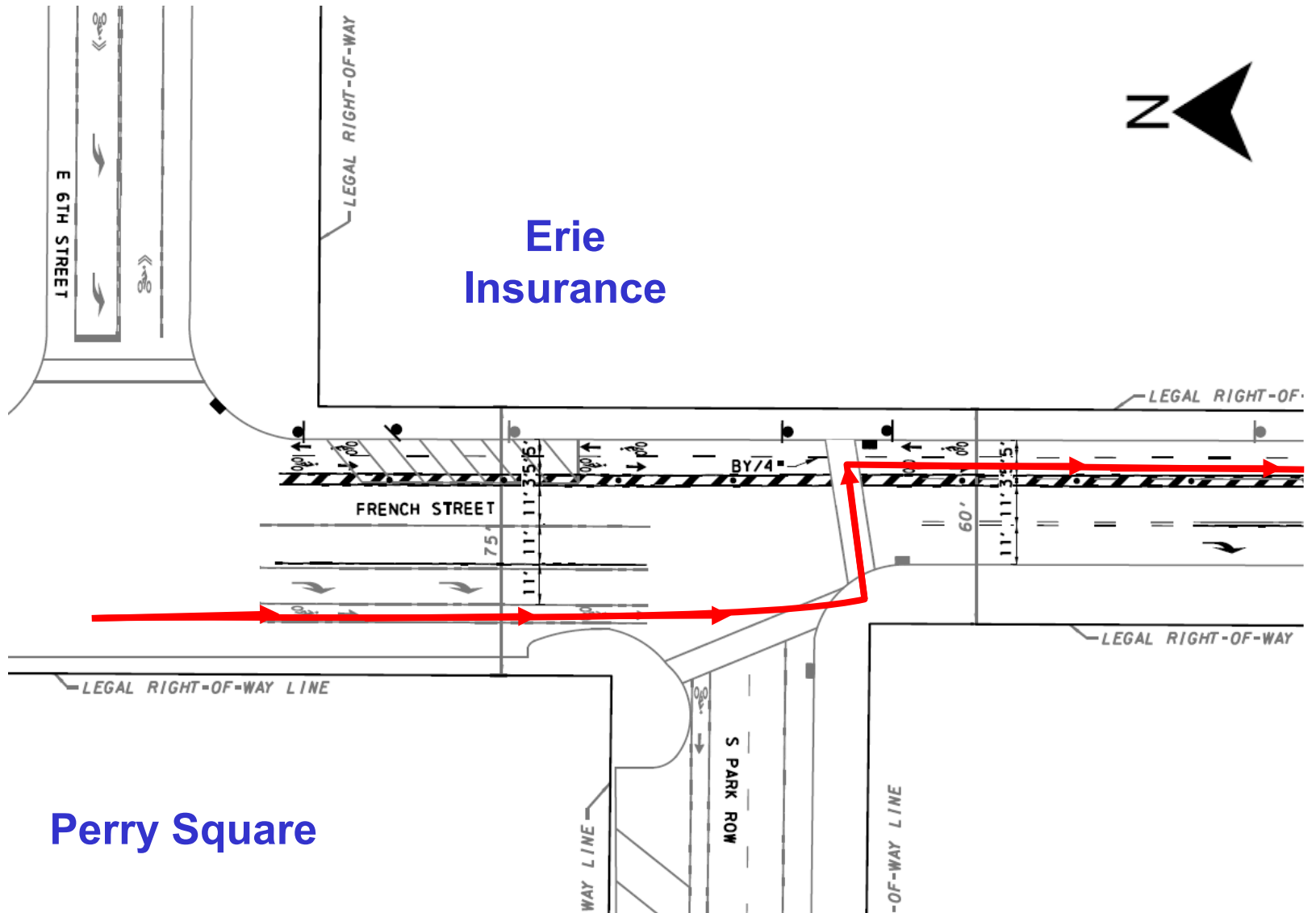



# French Street Bikeway

## SOUTHBOUND BIKE ACCESS TO S. PARK ROW & POINTS WEST

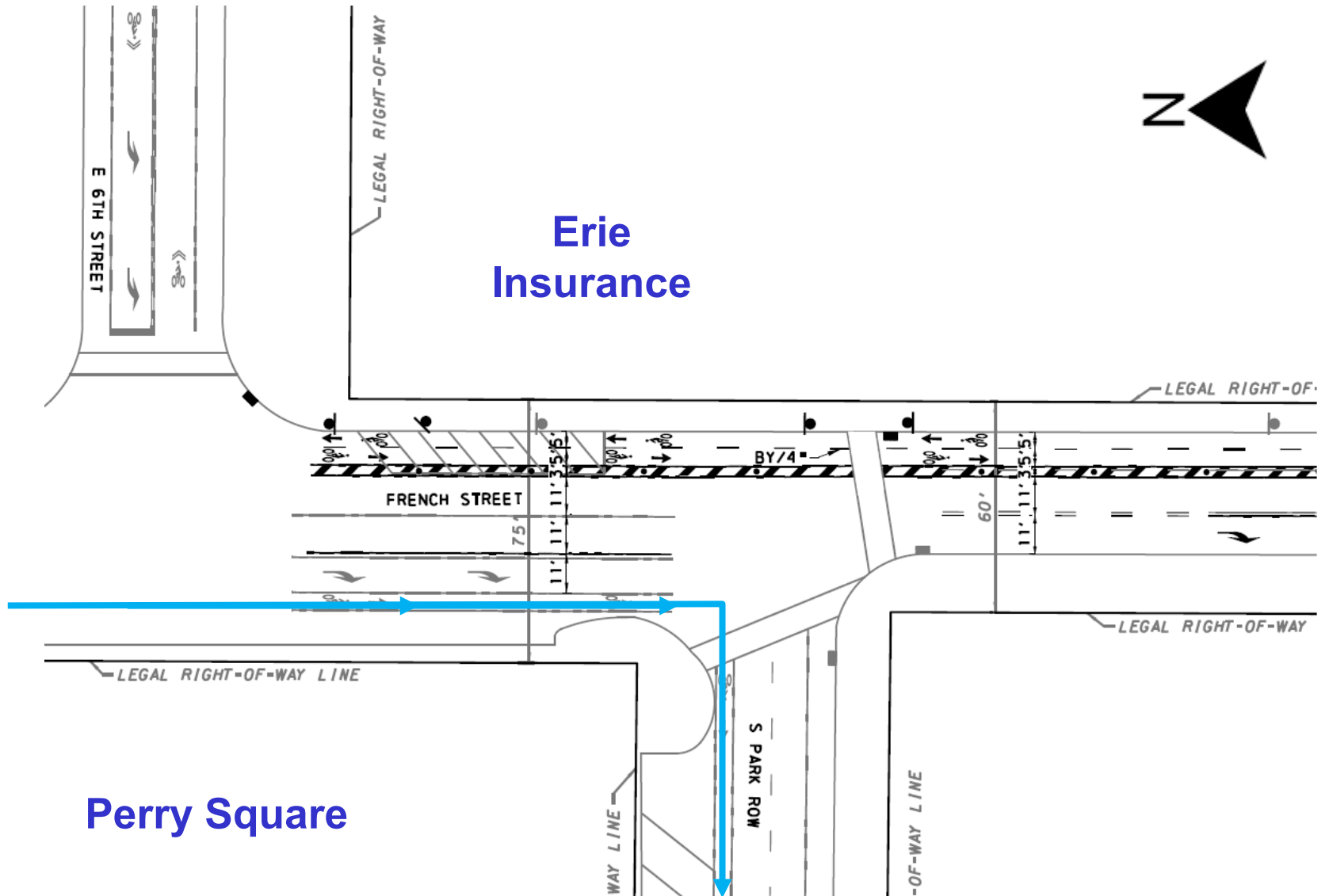

# French Street Bikeway

## TYPICAL SECTION

### French Street - E. 7th St. to E. 9th St.

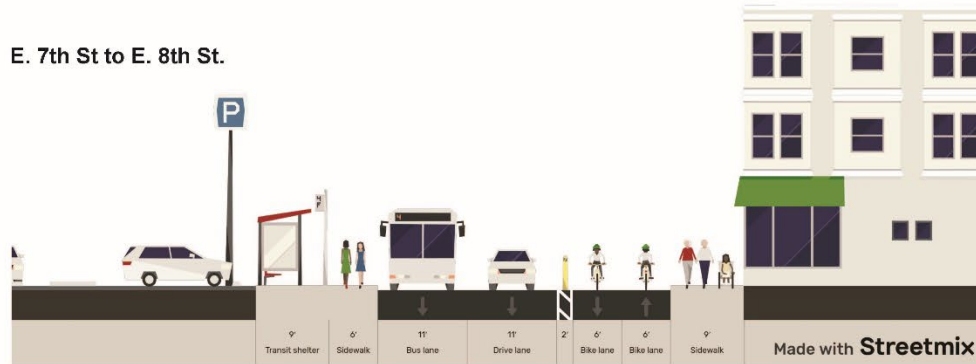

One one-way travel lane with on-street parking/bus stop and buffered two-way cycle track  
35.75 - 37.25 curb-to-curb width

### E. 8th St. to E. 9th St.

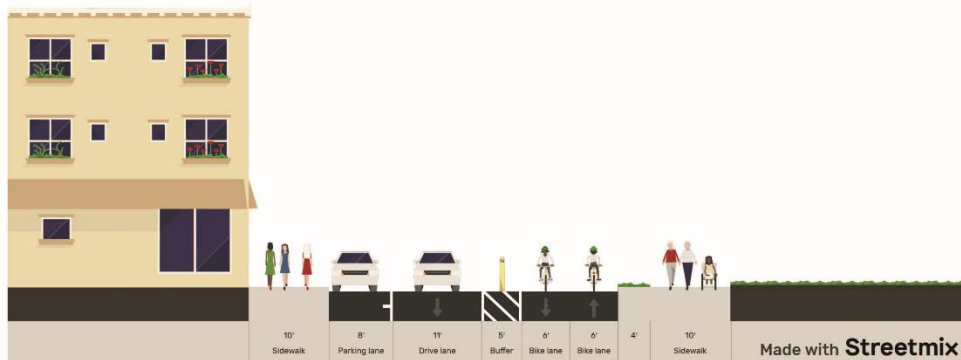

One one-way travel lane, on-street parking and buffered two-way cycle track  
28' - 36' curb-to-curb width

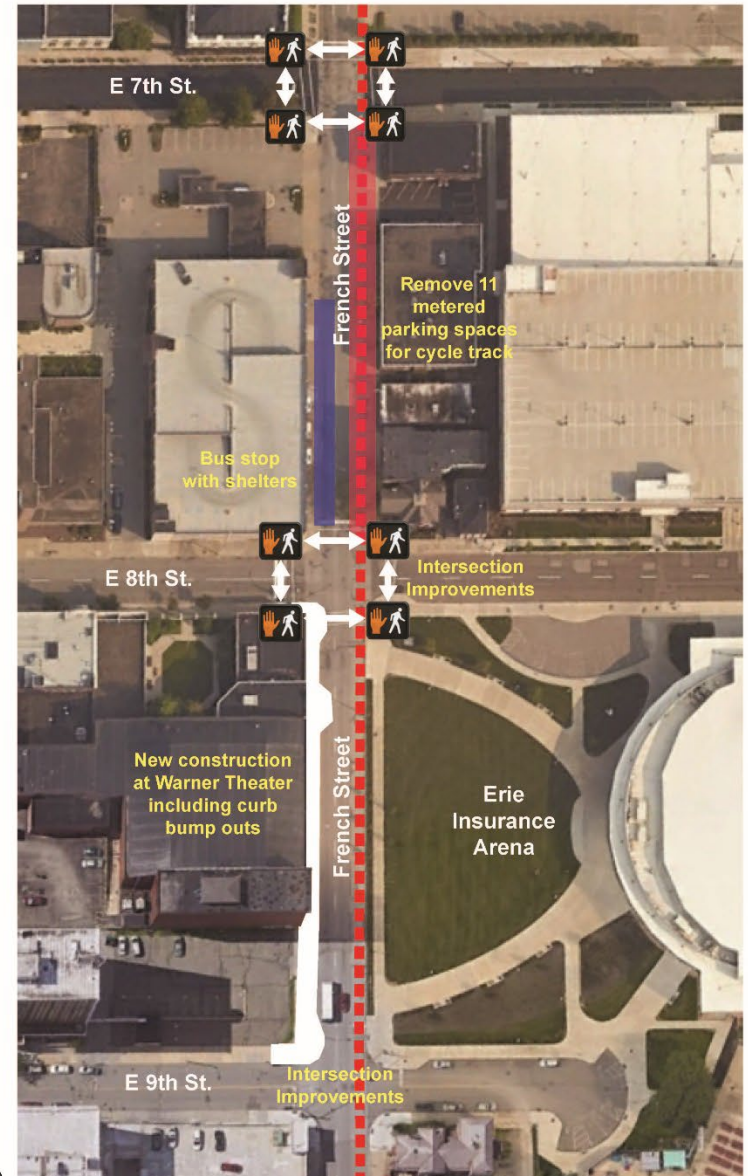

# French Street Bikeway

## TYPICAL SECTION

### French Street - E. 9th St. to E. 11th St.

#### E. 9th St to E. 10th St.

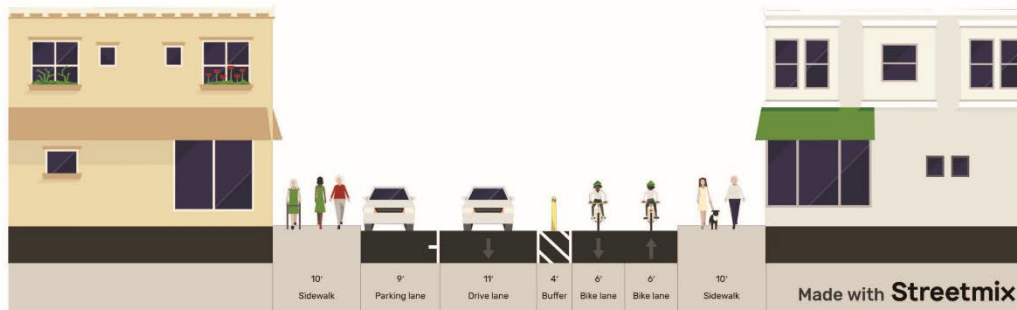

One one-way travel lane, on-street parking and buffered two-way cycle track  
36' - 37' curb-to-curb width

#### E. 10th St. to E. 11th St.

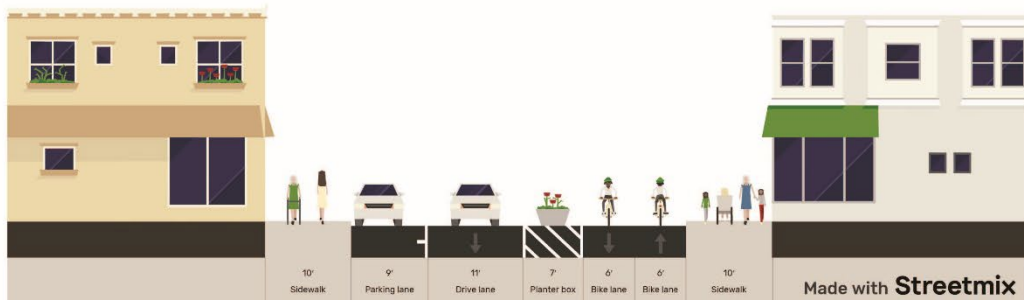

One one-way travel lane, on-street parking and buffered two-way cycle track  
39' - 39.5' curb-to-curb width





# French Street Bikeway

## TYPICAL SECTION

### French Street - E. 11th St. to E. 13th St.

#### E. 11th St to E. 12th St.

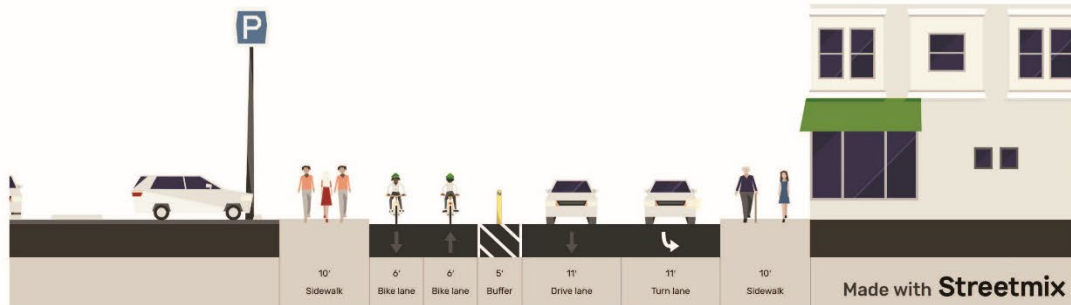

One one-way travel lane, left turn lane and buffered two-way cycle track  
38.9' curb-to-curb width

#### E. 12th St. to E. 13th St.

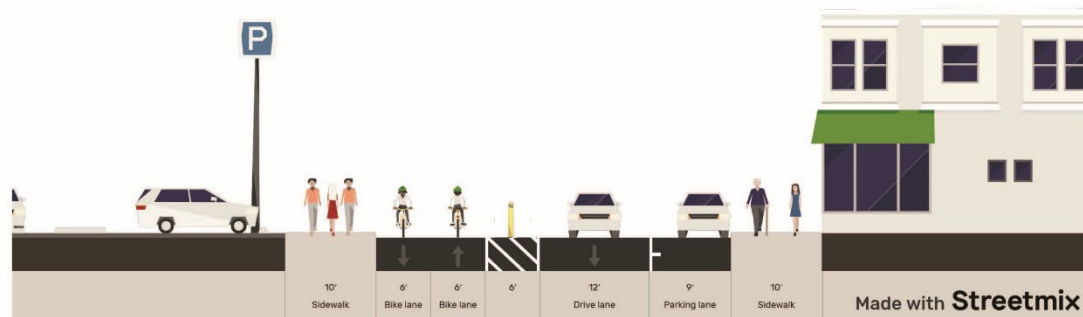

One one-way travel lane, on-street parking and buffered two-way cycle track  
38.3' - 39.8' curb-to-curb width





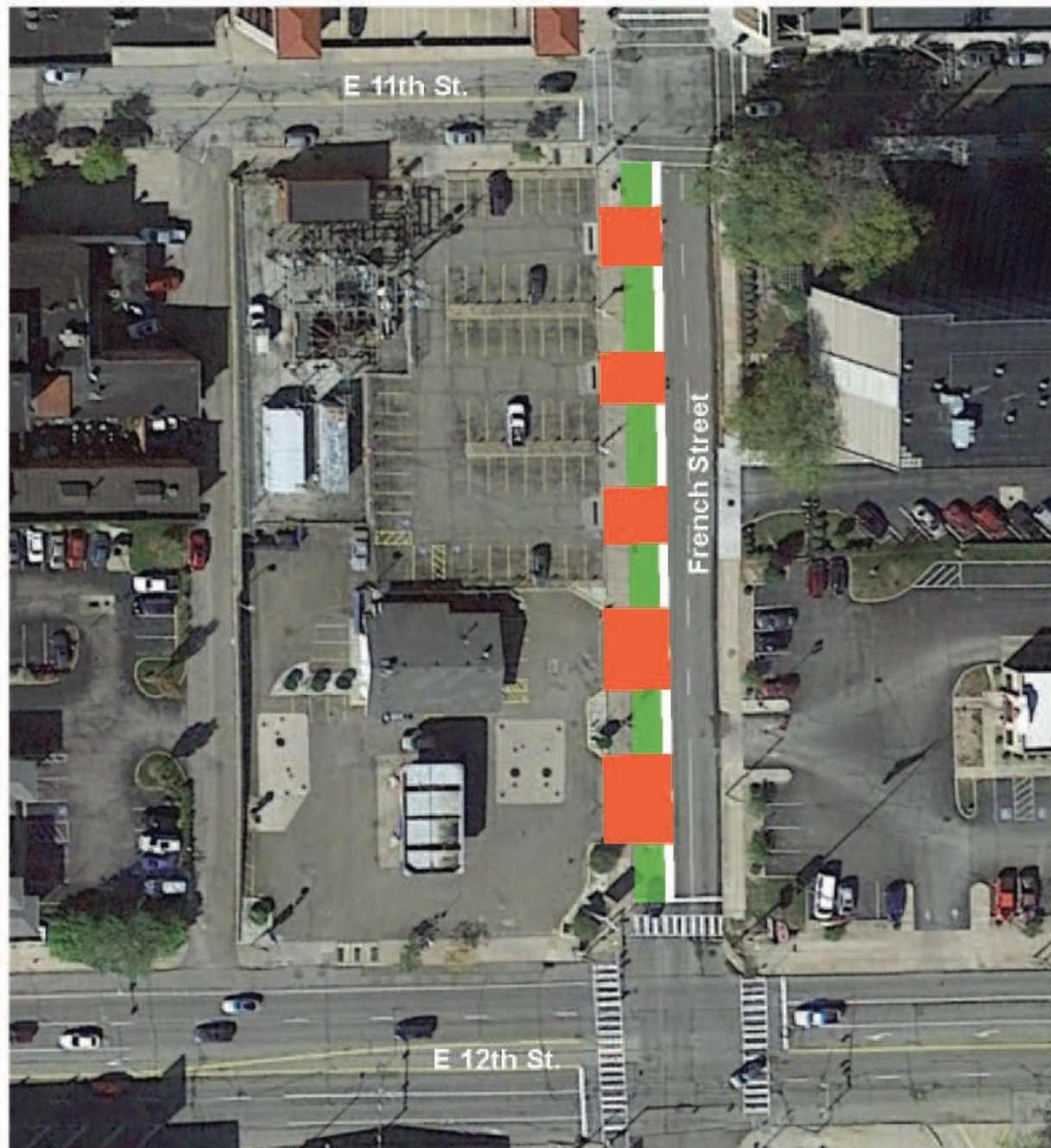

- Existing Driveway
- Proposed Cycle Track with buffer striping only

# French Street Bikeway

## TYPICAL SECTION

### French Street - E. 13th St. to E. 16th St.

#### E. 13th St to E. 14th St.

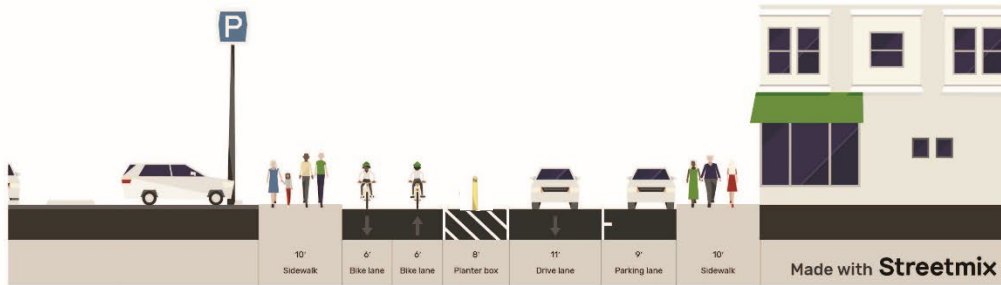

One one-way travel lane, on-street parking/school drop off, and buffered two-way cycle track  
39.8' - 40' curb-to-curb width

#### E. 14th St. to E. 16th St.

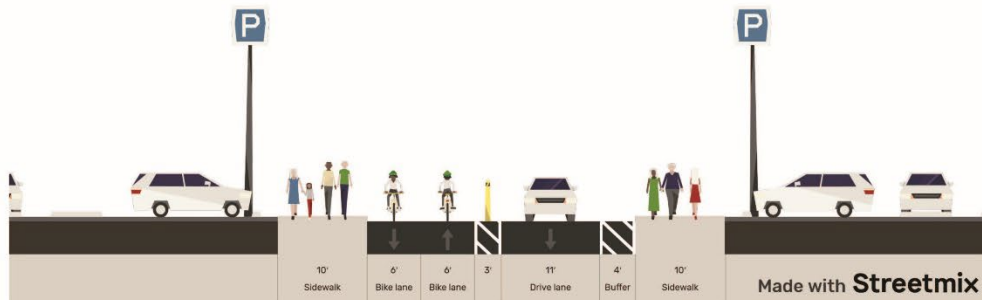

One one-way travel lane and buffered two-way cycle track  
30' - 32' curb-to-curb width





# French Street Bikeway

## TYPICAL SECTION

### French Street - E. 16th St. to E. 18th St.

#### E. 16th St to E. 17th St.

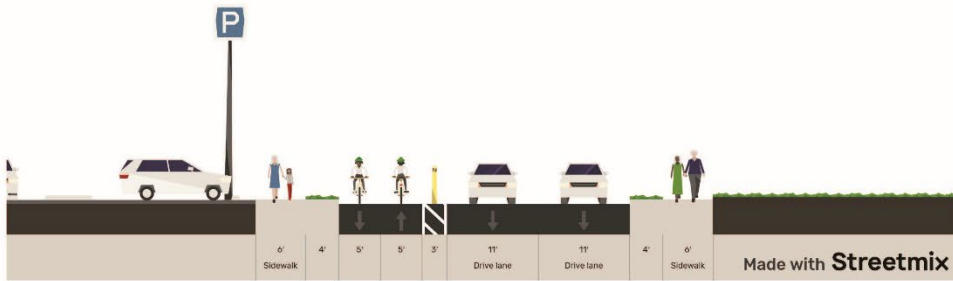

One one-way travel lane, on-street parking and buffered two-way cycle track  
35' curb-to-curb width

#### E. 17th St. to E. 18th St.

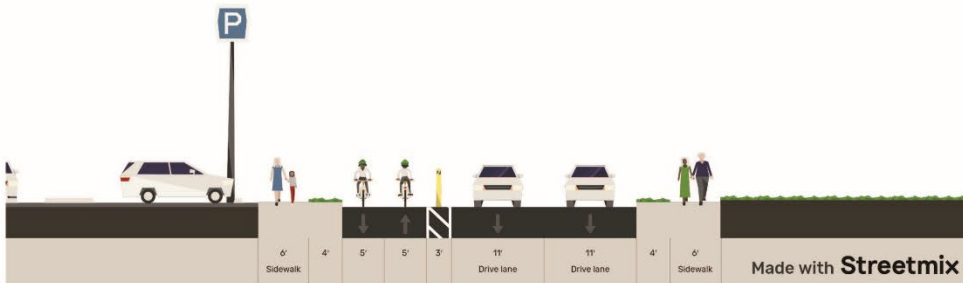

One one-way travel lane and buffered two-way cycle track  
35' curb-to-curb width



# French Street Bikeway

## TYPICAL SECTION

French Street - E. 18th St. to E. 26th St.

E. 18th St to E. 26th St.

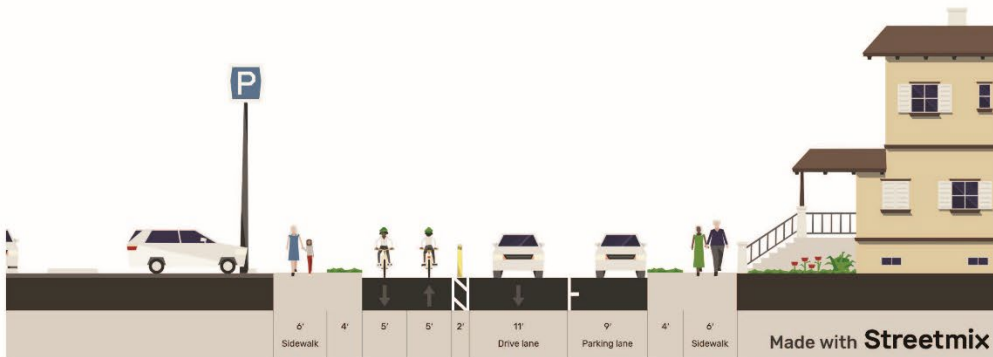

One one-way travel lane, on-street parking and buffered two-way cycle track  
32' curb-to-curb width





# French Street Bikeway

## TYPICAL SECTION

French Street - E. 26th St. to E. 38th St.

E. 26th St. to E. 38th St.

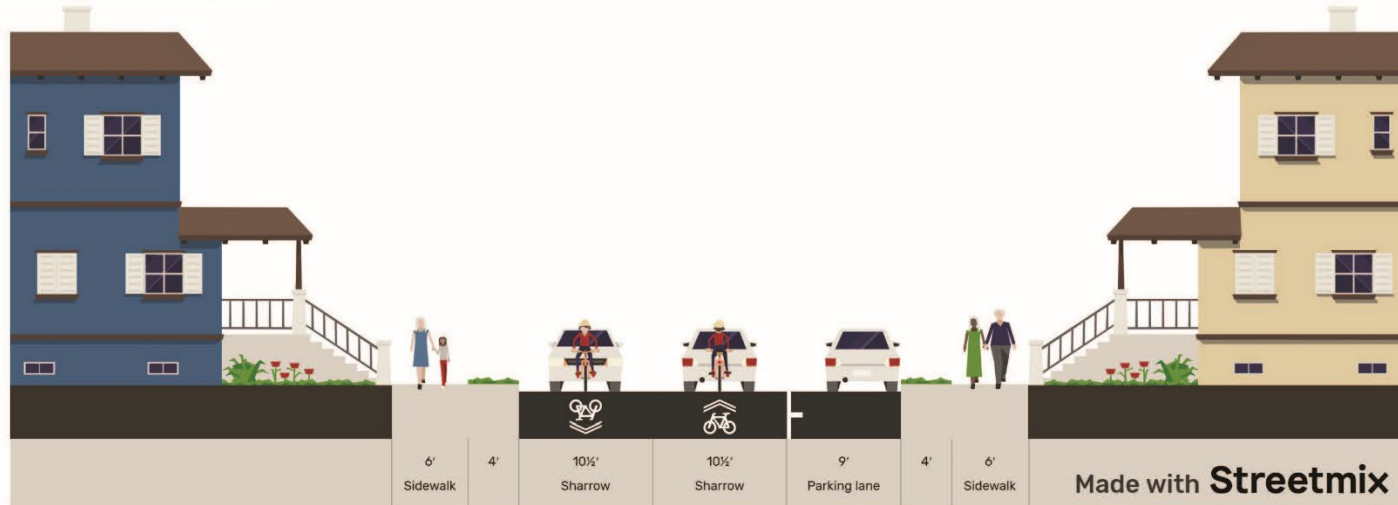

One travel lane each way with sharrows and alternating on-street parking  
30' - 36' curb-to-curb width

# French Street Bikeway

FULL PLAN SETS AVAILABLE FOR REVIEW ONLINE

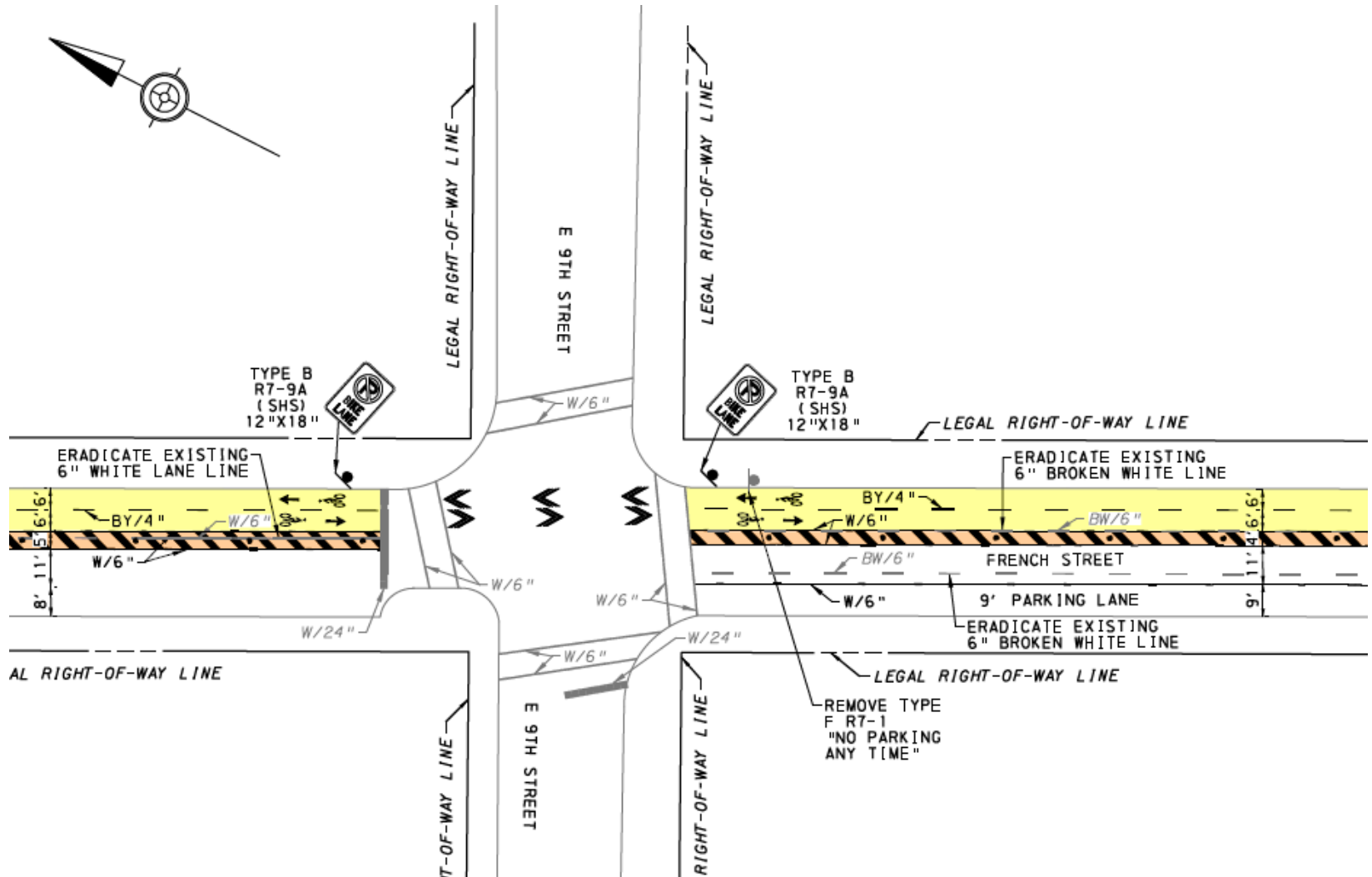

Visit <https://cityof.erie.pa.us/bikeway/>

## ERIE BIKEWAYS PROJECT

### We want to hear from you!

Visit <https://cityof.erie.pa.us/bikeway/> to review the following:

- This video recording
- PDF of the presentation slides
- Plans for improvements along Greengarden Boulevard between Bayfront Parkway and 38<sup>th</sup> Street
- Plans for improvements along French Street between 6<sup>th</sup> Street and 38<sup>th</sup> Street
- Online survey form
- Downloadable comment form

**Hard copies of the presentation, plans, and comment form are also available in the lobby of Erie City Hall at 626 State St., Erie, PA 16501.**



## ERIE BIKEWAYS PROJECT

**We want to hear from you!**

Comments will be accepted until Friday, February 3

Questions received during the public comment period will receive responses by Friday, February 17

You may also provide feedback by contacting:

**Bill Heiden**

**City of Erie Project Engineer**

**[whelden@erie.pa.us](mailto:whelden@erie.pa.us) or 814-870-1395.**

